

QUANTUM XR 4

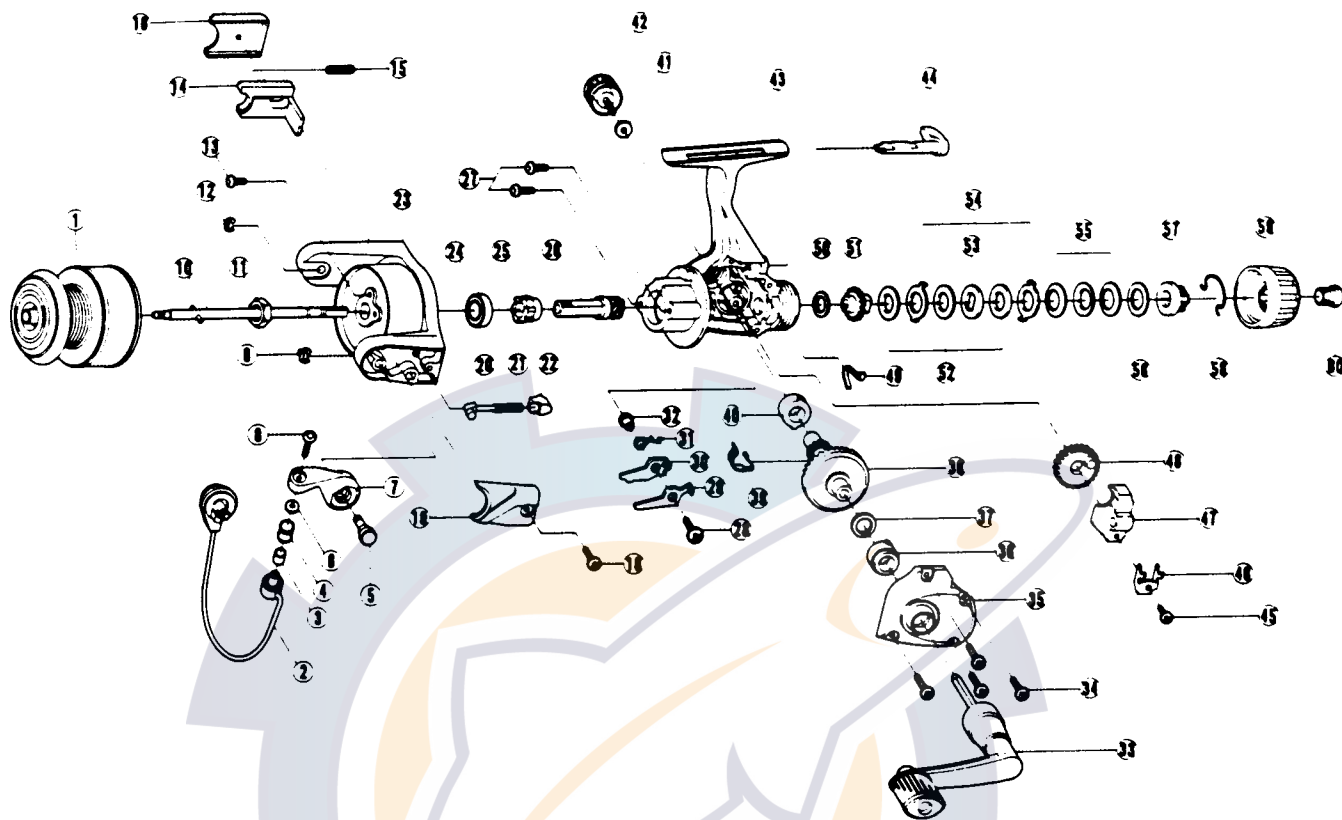

(XR4)
KEY PART
NO. NO.

| KEY NO. | PART NO. | DESCRIPTION | PRICE |
|---------|----------|---------------------------|-------|
| 1 | JU321-22 | SPOOL ASSEMBLY | 11.00 |
| 2 | GU347-08 | BAIL ASSEMBLY | 4.75 |
| 3 | MT016-02 | LINE ROLLER BUSHING | .75 |
| 4 | MT004-01 | LINE ROLLER | 1.20 |
| 5 | GU051-03 | ARM LEVER PIN | 1.00 |
| 6 | GU105-07 | LINE ROLLER WASHER | .15 |
| 7 | NU007-01 | ARM LEVER | .90 |
| 8 | KQ108-01 | LINE SLIDER SCREW | .30 |
| 9 | KQ034-01 | E-CLIP | .15 |
| 10 | JU315-03 | MAIN SHAFT ASSEMBLY | 1.95 |
| 11 | GU006-02 | ROTOR NUT | .80 |
| 12 | KQ034-01 | E-CLIP | .15 |
| 13 | GU077-04 | ROTOR NUT LOCK SCREW | .15 |
| 14 | JU019-01 | KICK LEVER | 1.00 |
| 15 | KQ049-01 | KICK LEVER SPRING | .25 |
| 16 | JU046-01 | KICK LEVER COVER | .75 |
| 17 | GU077-02 | KICK LEVER COVER SCREW | .15 |
| 18 | GU077-02 | ARM LEVER COVER SCREW | .15 |
| 19 | PU087-01 | ARM LEVER SPRING COVER | .80 |
| 20 | QL031-01 | ARM LEVER SPRING PIN | .75 |
| 21 | KQ049-02 | ARM LEVER SPRING | .85 |
| 22 | QL020-01 | ARM LEVER SPRING HOLDER | .30 |
| 23 | KU009-06 | ROTOR | 4.05 |
| 24 | AQ028-06 | BALL BEARING | 6.10 |
| 25 | JU060-01 | ANTIREVERSE RATCHET | 2.35 |
| 26 | JU011-01 | PINION GEAR | 2.30 |
| 27 | GU077-07 | BEARING SCREW | .60 |
| 28 | GU077-05 | ANTIREVERSE PAWL SCREW | .15 |
| 29 | JU063-01 | ANTIREVERSE PAWL "A" CNTR | .95 |
| 30 | JU074-01 | ANTIREVERSE PAWL "B" ON | .95 |

| KEY NO. | PART NO. | DESCRIPTION | PRICE |
|---------|----------|---------------------------|-------|
| 31 | JU061-01 | ANTIREVERSE PAWL SPRING | 1.00 |
| 32 | GU091-02 | ANTIREVERSE PAWL POST | .70 |
| 33 | GU318-25 | HANDLE ASSEMBLY | 5.65 |
| 34 | JU057-01 | BODY COVER SCREW | .60 |
| 35 | KU023-06 | BODY COVER | 3.75 |
| 36 | JU027-01 | GEAR SHAFT BUSHING | 1.55 |
| 37 | GU105-13 | ADJUSTMENT WASHER | .62 |
| 38 | JU012-01 | DRIVE GEAR | 3.35 |
| 39 | JU086-01 | SILENT CAM | 1.10 |
| 40 | JU027-01 | GEAR SHAFT BUSHING | 1.55 |
| 41 | GU105-01 | HANDLE SCREW WASHER | .10 |
| 42 | GU073-01 | HANDLE SCREW | .60 |
| 43 | KU001-06 | BODY | 4.05 |
| 44 | GU090-01 | ANTIREVERSE LEVER | 1.45 |
| 45 | JU100-02 | OSCILLATOR RETAINER SCREW | .60 |
| 46 | JU078-01 | OSCILLATOR SLIDE RETAINER | .30 |
| 47 | KU025-01 | OSCILLATOR SLIDER | 1.95 |
| 48 | KU053-01 | OSCILLATOR GEAR | 1.95 |
| 49 | GU089-01 | ANTIREVERSE LEVER SPRING | .50 |
| 50 | GU105-17 | DRAG FRICTION WASHER "A" | .77 |
| 51 | KU075-01 | DRAG CLICK GEAR | 1.40 |
| 52 | GU105-18 | DRAG DISC | .88 |
| 53 | JU080-01 | DRAG WASHER "D" | 1.00 |
| 54 | JU081-01 | DRAG WASHER KEYED | 1.00 |
| 55 | JU043-01 | DRAG SPRING | 1.30 |
| 56 | GU105-19 | DRAG WASHER | .93 |
| 57 | JU066-01 | DRAG NUT | 1.25 |
| 58 | JU083-01 | DRAG CLICK SPRING | 1.85 |
| 59 | JU032-01 | DRAG KNOB | 1.50 |
| 60 | JU101-01 | DRAG KNOB SCREW | 1.25 |

Prices subject to change without notice. Prices do not include postage and handling.

PLEASE ORDER BY PART NUMBER

Rev. 6/94

Zebco Division Brunswick Corporation, Box 270, Tulsa, OK 74101 USA 918-836-5581



BRUNSWICK